

REMOVAL AND INSTALLATION

Primary LOP	Related LOP	Description	Skill Level	Skill Category
23 30 57 01	-	Frame, sunroof Frame / Housing	2 - Skilled	1B
23 30 57 05	-	Frame, sunroof Tray, Roller Blind	2 - Skilled	1B

1. Lower the headliner in-vehicle (Refer to 23 - Body/Interior/HEADLINER/Removal and Installation).
2. Detach the front and rear drain tubes (1) from the sunroof.
3. With the help of two assistants holding the sunroof (3), remove the sunroof bolts (2).
4. Lower the sunroof, carefully rotate and remove it through the roof opening.

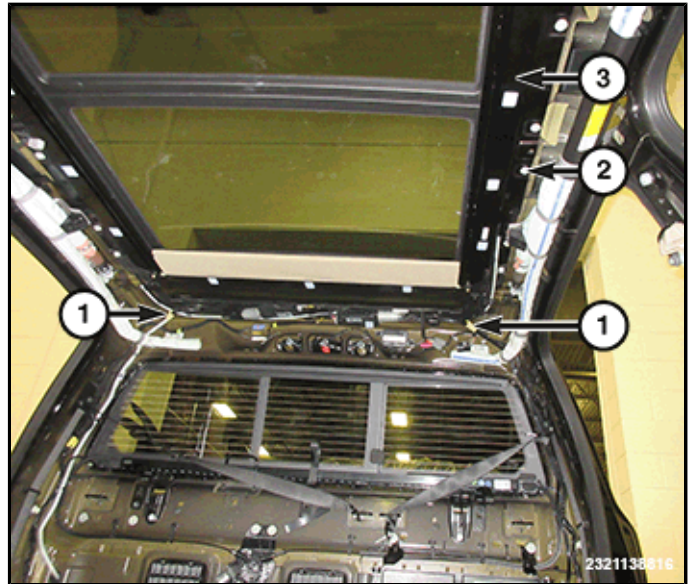

5. Place the sunroof on a workbench and inspect the roof seal for damage. A seal in good condition is shown as (1). If the seal is folded (2) as shown, or any other type of damage is observed, replace the seal with a NEW service part.

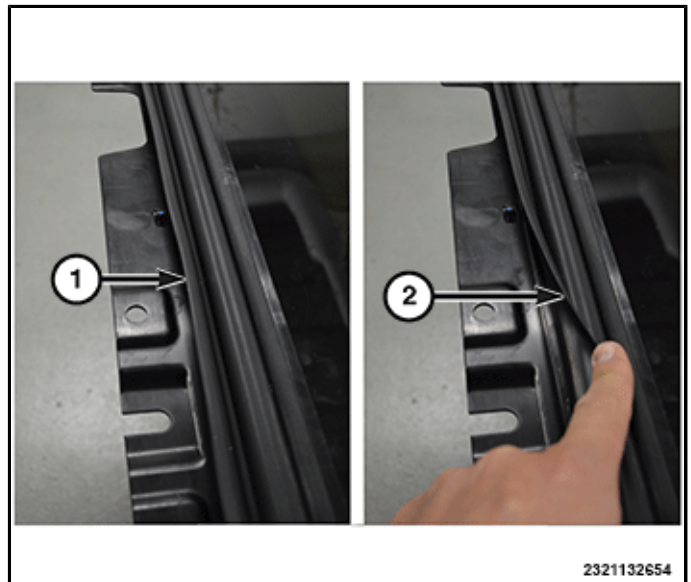

1. Place the sunroof on a workbench to inspect the roof seal.

2. Before installation, inspect the roof seal (1) for damage. If the seal is folded (2) as shown, or any other type of damage is observed, replace the seal with a NEW service part.

NOTE: It is very important to raise the sunroof straight up when installing, to prevent the seal from getting folded and causing a water leak.

3. With the help of two assistants, position the sunroof carefully in the vehicle then raise it slowly to the roof opening. Do not slide the sunroof in any direction while mating to the roof panel, it must be raised straight up in order to prevent seal folding. Loosely install the sunroof to body bolts.

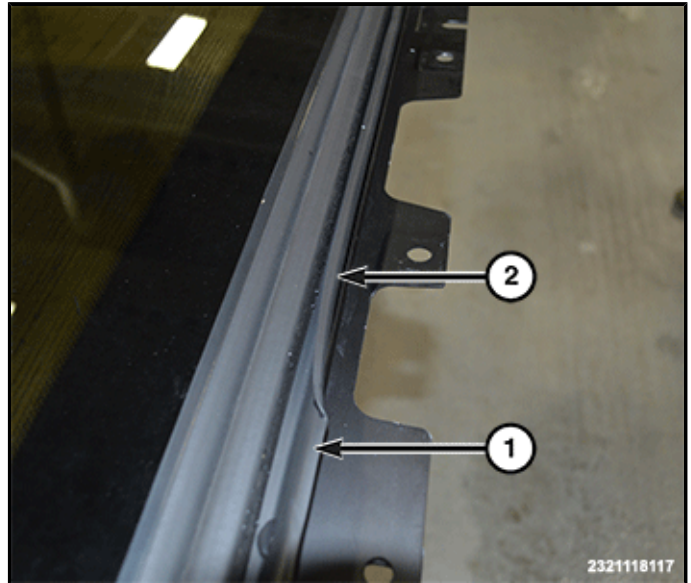

4. Inspect the seal around the perimeter of the sunroof opening (2), making sure it is seated evenly and shows no sign of folding (1) as shown in this graphic.

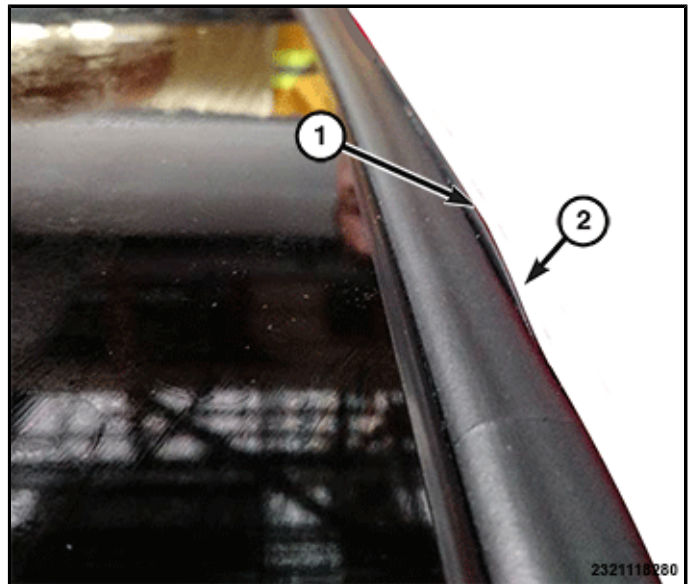

5. Using a .5mm plastic feeler gauge (1), check around the perimeter of the roof opening to evaluate seal (3) to roof (2) consistency. If the feeler gauge feels tighter or looser in areas, position the sunroof to get the desired consistency and tighten the sunroof bolts to the proper (Torque Specifications).

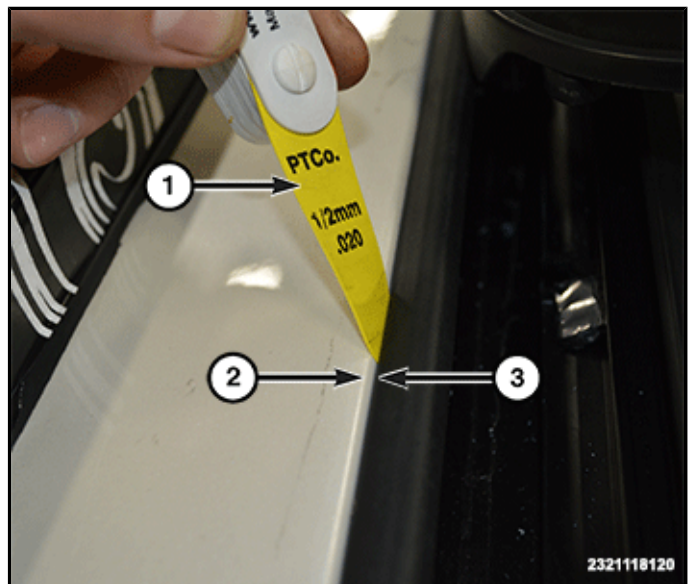

6. Attach the front and rear drain tubes to the sunroof.

7. Raise and support the headliner as necessary, and connect the wire harness connector to the sunroof and sunroof switches.
8. Connect the negative battery cable(s) (Refer to 08 - Electrical/Battery System/Standard Procedure).
9. Adjust the sunroof glass clearances (Refer to 23 - Body/Sunroof, GLASS, Sunroof/Adjustments).
10. Perform the Sunroof Initialization and Obstacle Detection Calibration procedure (Refer to 08 - Electrical/Power Top/MOTOR, Sunroof/Standard Procedure).
11. Disconnect and isolate the negative battery cable(s) (Refer to 08 - Electrical/Battery System/Standard Procedure).
12. Install the headliner (Refer to 23 - Body/Interior/HEADLINER/Removal and Installation).